

## HOW DO I KEEP MY HEARING AID(S) CLEAN? (RIC/BTE)



- Clean hearing aids daily due to wax or dirt that may clog the microphone. Brush the tip of the rubber dome. If using an earmold, brush the sound bore – the hole at the end of the earmold.
- Use the brush to also clean the areas around the microphone, receiver, and controls. Scoop any debris from the sound bore using the wax loop.



Use the wax loop to remove any wax from the hole at the end of the earmold by inserting it into the hole and scooping out any debris in the area.

Use the brush to remove any debris from the microphones and receiver.

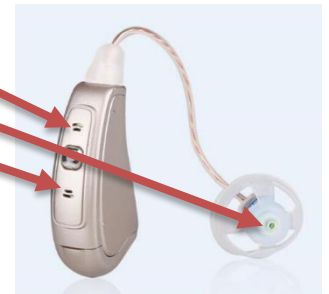

## WHAT DO I DO IF I CANNOT HEAR WELL FROM MY HEARING AID(S) OR IT WON'T TURN ON?

- Check battery is in the battery compartment – flat side facing up and sticker removed. Remember after removing the sticker, let the battery activate with air for 2 minutes before inserting it in the hearing aid.
- If problem continues, change the wax guard found in the tip of the receiver (remove rubber dome prior to changing, and see instruction on wax guard packaging). If using an earmold, use the wax loop to scoop out any debris from the sound bore. Also use the cleaning brush to clean the areas around the microphone and controls.
- If hearing aid(s) is still not working, call Sound Hearing Clinic at 604-687-1488